

TD4N | 4 Corner Super Radius | Modular Type

Q max High Efficient	 Roughing	 Semi Finishing	HRC 55	No. of Teeth 2-6
--------------------------------	---	---	------------------	----------------------------

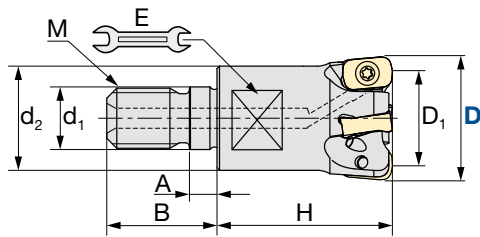
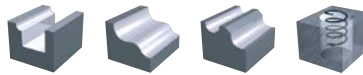

Diameter Holder only	CAM Radius	Fastening Torque
-0.06/-0.11 mm	2.0 mm	1.1 Nm

ID Code	Item Code	Z	Size [mm]									Inserts
			D	D ₁	H	A	B	d ₁	d ₂	M	E	
FH603	TD4N-2016M-2	2	16	10	25	5.5	17	8.5	12.8	M8	10	ENMU0603ER-B ENMU0603ER-C
FH604	TD4N-2020M-3	3	20	14	30		19	10.5	17.8	M10	15	
FH605	TD4N-2025M-4	4	25	19	35		22	12.5	20.8	M12	17	
FH606	TD4N-2032M-5	5	32	26	40	6.0	23	17.0	28.8	M16	22	
FH607	TD4N-2035M-5		35	29								
FH608	TD4N-2040M-6		40	34								
FH609	TD4N-2042M-6	6	42	36								

TD4N | 4 Corner Super Radius | Shank Type

Q max High Efficient	 Roughing	 Semi Finishing	HRC 55	No. of Teeth 2-6
--------------------------------	--	--	------------------	----------------------------

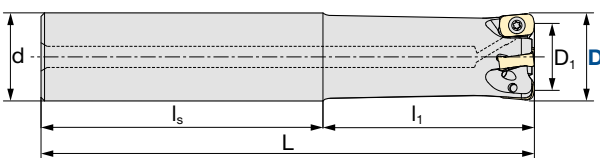
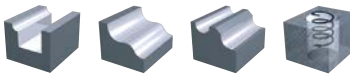
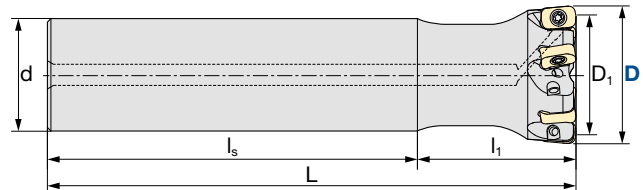
Fig. 1: Standard Type

Fig. 2: Undercut Type

Diameter Holder only	CAM Radius	Fastening Torque
-0.06/-0.11 mm	2.0 mm	1.1 Nm

ID Code	Item Code	Z	Size [mm]							Shape	Inserts
			D	D ₁	L	l ₁	l _s	d			
FH610	TD4N-2016S-2	2	16	10	100	30	70	16	Fig.1	ENMU0603ER-B ENMU0603ER-C	
FH615	TD4N-2016L-2				150	50	100				
FH611	TD4N-2020S-3				130	80	80				20
FH616	TD4N-2020L-3	160	80								
FH612	TD4N-2025S-4	140	60								
FH617	TD4N-2025L-4	4	25	19	180	100	25				
FH613	TD4N-2032S-5	5	32	26	150	70	32	Fig.2			
FH618	TD4N-2032L-5				200	120					
FH614	TD4N-2040S32-6				150	45					105
FH619	TD4N-2040L32-6	6	40	34	220	175	175				

※ S = Short · L = Long

NOTE: Specifications for the products listed in this catalog are subject to change without notice due to replacement or modification.

INSERTS | TD4N

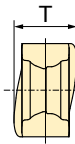
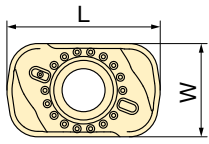

Fig. 1: ENMU0603ER-B
Low cutting force geometry
For SUS and sticky materials

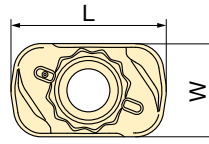

Fig. 2: ENMU0603ER-C
Reinforced edge geometry
For general use
For hard material, interrupt milling

Inserts	Size (mm)				Grade				Tolerance Class	Type
	L	W	T	CAM R	GX2140	JM4160	JS4045	JP4120		
Item code					ID Code					
ENMU0603ER-B	10	6	4.2	2.0	WF785	WF784	WF783	WF782	M	Fig. 1
ENMU0603ER-C					WF781	WF780	WF779	WF778		Fig. 2





B Type
For lower cutting force.
Recommended for sticky material like Stainless Steel

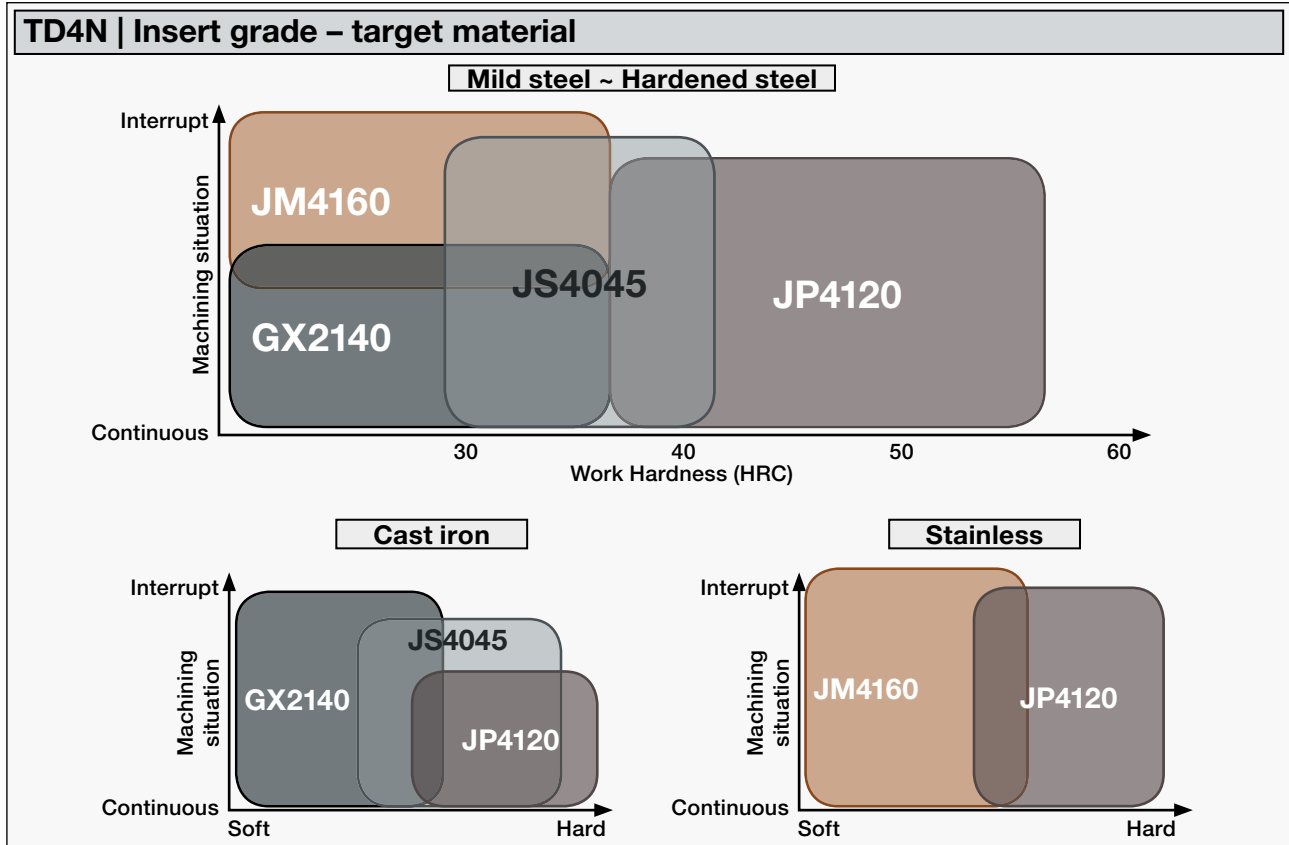

C Type
For general usage.
Same strength as high feed item.
Against chip biting, vibration, crater wear

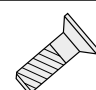

Parts	Clamp Screw				Wrench / Torque Blade		
	ID Code	Item Code	Type	Fastening Torque	Description	ID Code	Item Code
Cutter Body	ET175	250-141(A)	Standard Screw (T8)	1.1 Nm	T8 Wrench	ET013	104-T8
	ET177	250-141/B	Low Head Screw (7IP)		7IP Torque Blade for Torque-Fix (NT163)	NT237	7IP-Torque
Shape							

NOTE: In some situations, chips could flow across screw during machining. In this case please use screw **250-141/B** with lower head to avoid wear of screw. To tighten "Low Head Screw" please use a **7IP wrench** or blade. **7IP blade** (NT237) can be used with torque screwdriver from "Torque-Fix (NT163)".

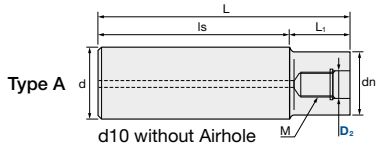
ASC | Carbide Shanks for Modular Mills

*ASC Carbide Shanks [mm]													
Fits Modular:	ID Code	Item Code	D ₂	M	L	L ₁	Is	dn	dn ₂	d	Type	Airhole	
D8** D10** D12	FH137	ASC10-6.5-74-24	6.5	M6	74	24	50	9.3	-	10	A	No	
	FH254	ASC10-6.5-84-34			84	34							
	FH255	ASC10-6.5-114-24			114	24							90
	FH138	ASC10-6.5-114-49				49							65
D25**	FH145	ASC25-12.5-145-65	12.5	M12	145	65	80	23	-	25	A	Yes	
	FH265	ASC25-12.5-215-115			215	115							100
	FH266	ASC25-12.5-265-145			265	145							120
	FH267	ASC25-12.5-315-195			315	195							
	FH146	ASC25-12.5-265-65			265	65							200
	FH268	ASC25-12.5-315-65			315								250
D30** D32** D40**	FH147	ASC32-17-160-80	17	M16	160	80	80	28	-	32	A	Yes	
	FH269	ASC32-17-260-140			260	140							120
	FH270	ASC32-17-360-240			360	240							
	FH148	ASC32-17-310-80			310	80							230

* ASC Carbide Shanks can be used with SUPER Lock Milling Chucks or Shrink-Fit Holders.

** Since the cutter diameter is below the shank diameter, interference occurs at the shank.

*** For D40 it is recommended that the protrusion length is 200mm or less.

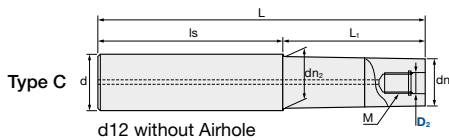

*ASC Carbide Shanks [mm]													
Fits Modular:	ID Code	Item Code	D ₂	M	L	L ₁	Is	dn	dn ₂	d	Type	Airhole	
D8** D10** D12	FH139	ASC12-6.5-74-24	6.5	M6	74	24	50	11	11.5	12	C	No	
	FH256	ASC12-6.5-94-44			94	44							
	FH257	ASC12-6.5-129-24			129	24							105
	FH140	ASC12-6.5-129-64				64							65
D16**	FH141	ASC16-8.5-95-30	8.5	M8	95	30	65	14.5	15.5	16	C	Yes	
	FH258	ASC16-8.5-120-55			120	55							
	FH142	ASC16-8.5-140-75			140	75							
	FH259	ASC16-8.5-160-95			160	95							
	FH260	ASC16-8.5-160-30				30							130
D20**	FH143	ASC20-10.5-120-50Z	10.5	M10	120	50	70	18.5	19.5	20	C	Yes	
	FH261	ASC20-10.5-170-90Z			170	90							80
	FH262	ASC20-10.5-220-120Z			220	120							100
	FH263	ASC20-10.5-270-150Z			270	150							120
	FH144	ASC20-10.5-220-50Z			220	50							170
	FH264	ASC20-10.5-270-50Z			270								220

* ASC Carbide Shanks can be used with SUPER Lock Milling Chucks or Shrink-Fit Holders.

** Since the cutter diameter is below the shank diameter, interference occurs at the shank.



TD4N | 4 Corner Super Radius | Modular Type

➔ For more information about Modular Tools and available Chucks please check our brochures:

